

- ▽ TELLER UNIT TO BE SUPPORTED BY TOP CAP (WEIGHT 60 POUNDS).
- ▽ FOUR (4) HOLES IN TOP FOR DROP CEILING WIRE EYE-BOLTS OR 3/8" THREADED ROD.
- ▽ 110V 1PH, 20 AMP CIRCUIT REQUIRED FOR EACH CUSTOMER UNIT FROM CANOPY OR UNDERGROUND. (SEE CUSTOMER BASE AND TOP CAP DIAGRAM FOR CONDUIT LOCATIONS)

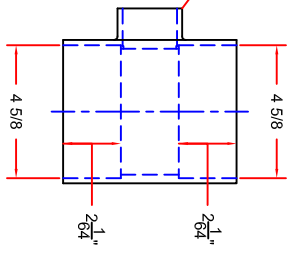

5 X SCALE VIEW
 23122991 TS PVC SUCTION FITTING
 OPTIONAL 23122994 FOR STEEL RADIUS TUBE

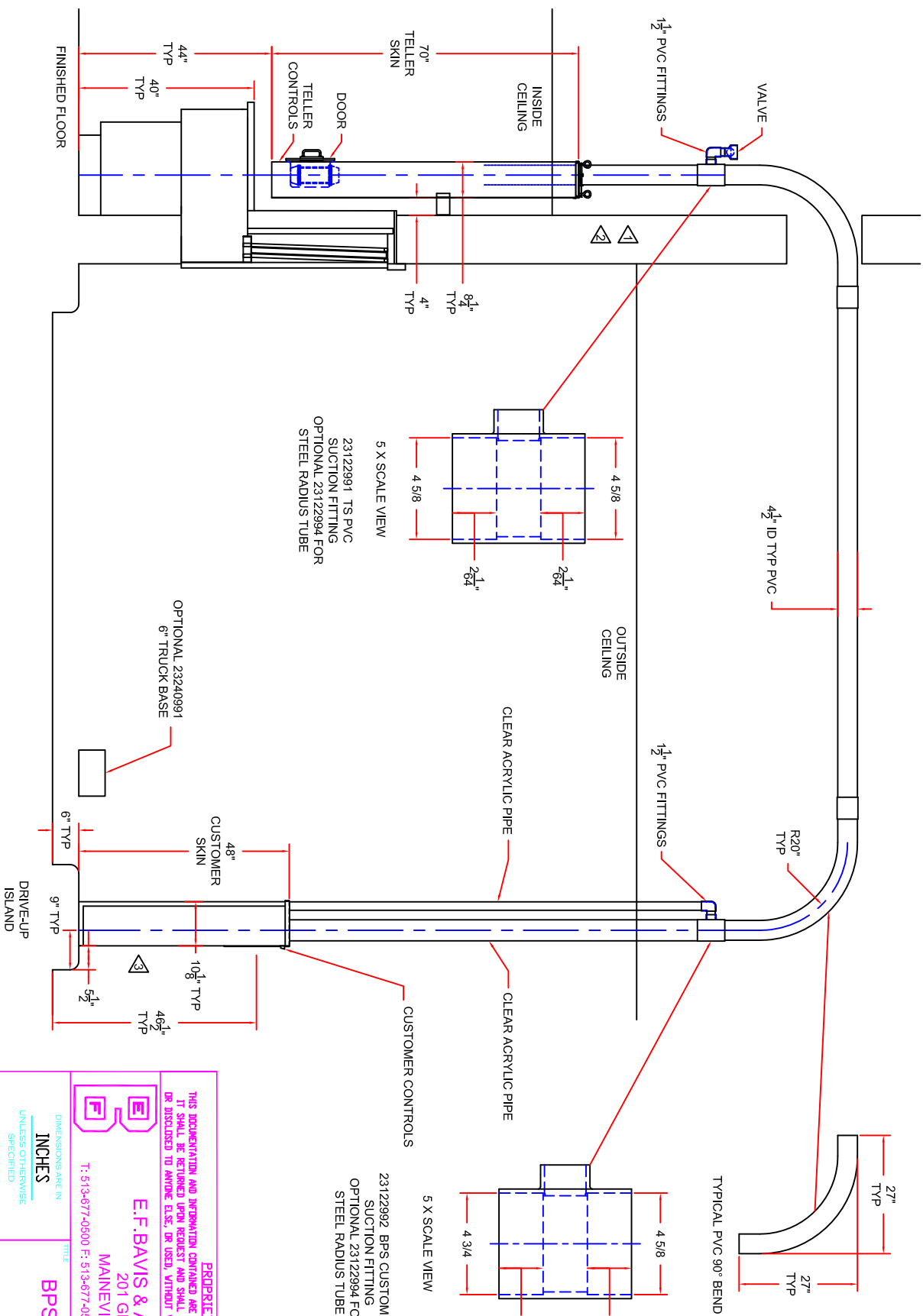
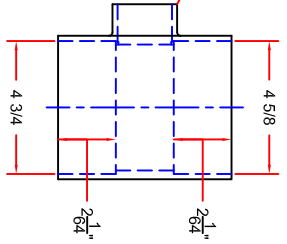
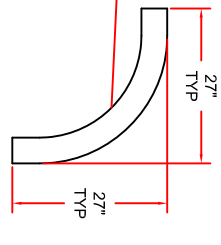

5 X SCALE VIEW
 23122992 BPS CUSTOMER SUCTION FITTING
 OPTIONAL 23122994 FOR STEEL RADIUS TUBE

PROPRIETARY

THIS DOCUMENTATION AND INFORMATION CONTAINED HERE IS THE SOLE PROPERTY OF E.F. BAVIS & ASSOC., INC. IT SHALL BE RETURNED UPON REQUEST AND SHALL NOT BE REPRODUCED IN WHOLE OR IN PART, OR DISCLOSED TO ANYONE ELSE, OR USED, WITHOUT WRITTEN CONSENT OF E.F. BAVIS & ASSOC., INC.

E.F. BAVIS & ASSOCIATES INC.
 201 GRANDIN RD.
 MAINEVILLE, OH 45039

T: 513-677-0500 F: 513-677-0552 E: info@efbavis.com www.efbavis.com

DRAWN	MGRANVEN	05/15/08	A	DATE	05/15/08	
TITLE	BPS Typical Pneumatic System Layout					
DIMENSIONS ARE IN INCHES UNLESS OTHERWISE SPECIFIED						
SHEET	1				OF	1